

# Fiber Optics

## Hybrid adapter Portfolio

Edition 2017/11

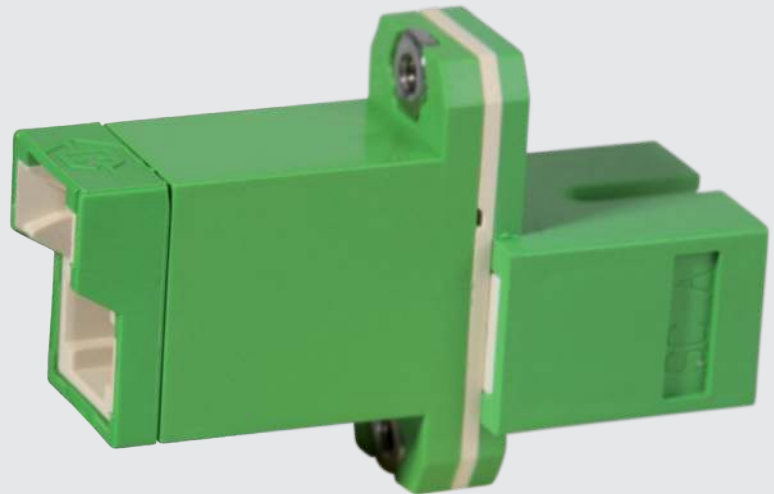

# Hybrid adapters

## LSH-FC/2-hole flange

	Adapter type	Colour	Features	Item no.	Description	Packing unit
	SM	blue	wide key	22664001	FLSH-FC-D101	1
	SM	green	wide key	22664002	FLSH-FC-D601	
	SM	green	small key	22664020	FLSH-FC-D602	

## LSH-SC/2-hole flange

	Adapter type	Colour	Item no.	Description	Packing unit
	SM	blue	22664005	FLSH-FSC-D101	1
	SM	green	22664006	FLSH-FSC-D601	

## SC-FCPC/2-hole flange

	Adapter type	Colour	Features	Item no.	Description	Packing unit
	SM	blue	wide key	22651707	FSC-FC-D101	1
				84030646	FSC-FC-D101_100-P	100
	SM	green	small key	84082573	FSC-FC-D600	1
				84030205	FSC-FC-D600_100-P	100

## SC-FC/snap-in flange

	Adapter type	Colour	Features	Item no.	Description	Packing unit
	SM	blue	wide key	23010314	FSC-FC-A100	1
	SM/MM	black	wide key	23010315	FSC-FC-A101	
	SM	green	small key	84030224	FSC-FC-A600_100-P	100

## ST-FC

	Adapter type	Features	Item no.	Description	Packing unit
	SM/MM	wide key	22649103	FST-FC-C100	1

Adapter dimensions

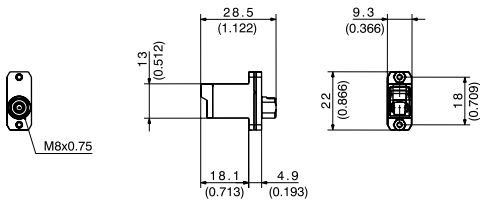

Installation dimensions

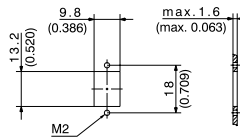

Adapter dimensions

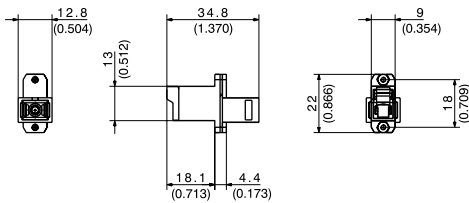

Installation dimensions

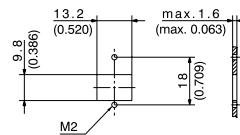

Adapter dimensions

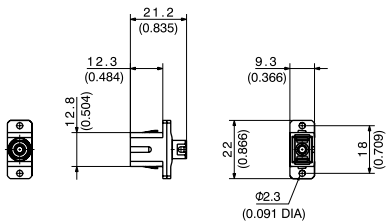

Installation dimensions

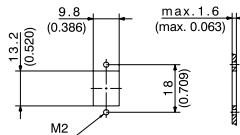

Adapter dimensions

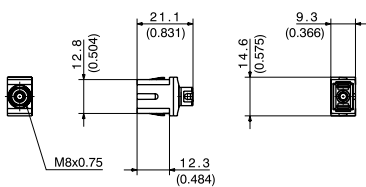

Installation dimensions

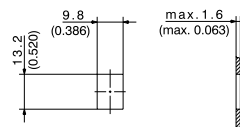

Adapter dimensions

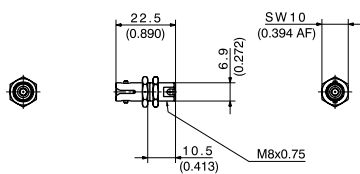

Installation dimensions

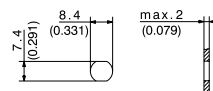

# Hybrid adapters

## SC-ST/2-hole flange

	Adapter type	Colour	Item no.	Description	Packing unit
	SM	blue	22651708	FSC-FST-D100	1
	SM/MM	black	23004792	FSC-FST-D101_100-P	100

## SC-ST/snap-in flange

	Adapter type	Colour	Item no.	Description	Packing unit
	SM	blue	23010316	FSC-FST-A100	1

## SC-ST duplex/2-hole flange

	Adapter type	Colour	Item no.	Description	Packing unit
	MM	beige	22659199	FSC-FST-D100-02_100-P	100

## SC-LC/snap-in flange

	Adapter type	Colour	Item no.	Description	Packing unit
	SM	blue	23029196	FSC-FLC-A100	1

Adapter dimensions

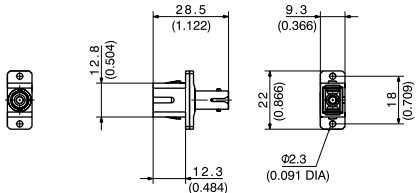

Installation dimensions

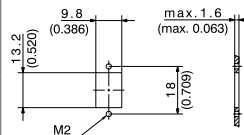

Adapter dimensions

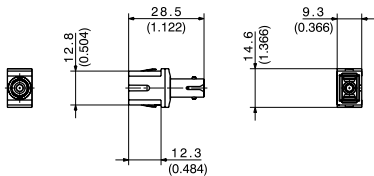

Installation dimensions

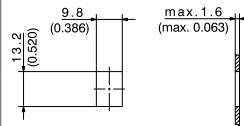

Adapter dimensions

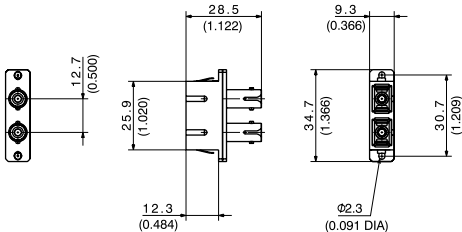

Installation dimensions

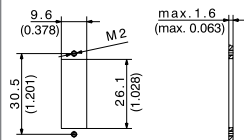

Adapter dimensions

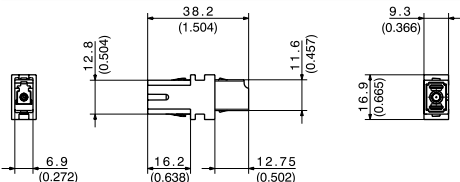

Installation dimensions

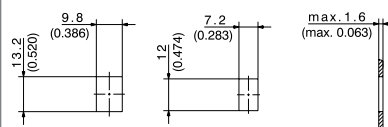

HUBER+SUHNER AG  
Fiber Optics Division  
Degersheimerstrasse 14  
9100 Herisau  
Switzerland  
Tel. +41 71 353 4111  
Fax +41 71 353 4444  
hubersuhner.com

HUBER+SUHNER is certified according to ISO 9001, EN(AS)9100, ISO 14001, ISO/TS 16949 and IRIS.

**Waiver**

Fact and figures herein are for information only and do not represent any warranty of any kind.